

Part#: 2836  
Rev: D

## **Handle Set Installation Instructions – Active Configuration**

### **Swing Patio Door Instructions**

Tools required:

- #2 Phillips screwdriver.

Notes:

- Handles and escutcheon plates vary in style. Right hand Regency handle set is shown.
- Please ensure box contents before proceeding with the installation.
- For proper operation, the door hardware must be installed in the order shown.

Box Contents:

- One (1) Exterior handle assembly.
- One (1) Interior handle assembly.
- Key cylinder kit:
  - One (1) Key cylinder.
  - Two (2) keys.
- One (1) Spring cassette
- One (1) Spindle
- Two (2) handle screws.
- One (1) Z-Clip
- One (1) exterior handle gasket.

### **Assembly: Refer to Figure 1 when assembling handle set to door**

1. Remove top pad screw. Install the key cylinder into the exterior plate. Insert the Z-Clip over the key cylinder and secure it by inserting the pad screw that was removed.
2. Apply the gasket to the flat inner surface of the escutcheon plate of the exterior handle assembly. If a foam gasket is provided, remove appropriate cutouts to allow gasket to fit over key cylinder.
3. Insert spindle into exterior handle assembly
4. Place exterior handle assembly against exterior door stile as shown in the figure. The handle of the assembly should point toward the hinges of the door and the key cylinder tail should be in the horizontal position to align with the slot in the door. If the slot in the door is not in the horizontal position, rotate it with a flat bladed screwdriver.
5. Rotate the thumbturn on the interior handle assembly to the vertical position so that it is aligned with the key cylinder tail (Note: Key cylinder tail in horizontal position should align with horizontal slot in the thumbturn shaft). Place the interior handle set onto the interior side of the door, capturing the spindle into the square hole of the handle (Note: handle should point toward hinges) and the spring cassette inside of the escutcheon plate as shown in the figure (Note: Some escutcheon plates have rectangular ribs inside to hold the spring cassette). Continue to push handle assembly until the thumbturn shaft engages the key cylinder tail. Insert both screws provided in the fastener kit and tighten.

Part#: 2836  
Rev: D

6. Check the operation of the handle. If the door does not lock, remove the exterior handle assembly and rotate the key cylinder tail 180 degrees and then reinstall the handle assembly.

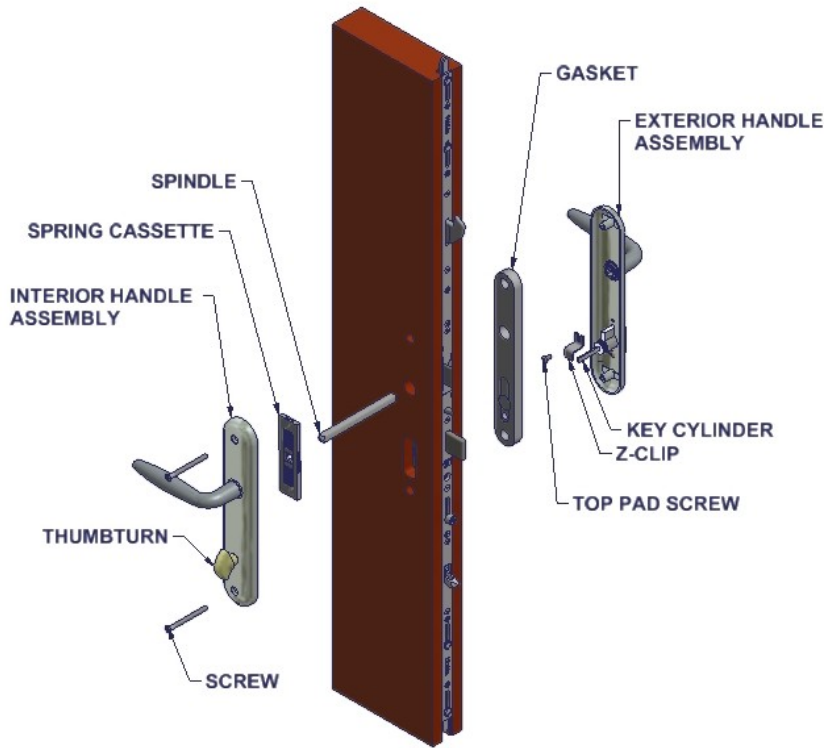

**Figure 1A (Thumb turn below handle):  
Handle orientation for  
AmesburyTruth Multi  
Point Lock systems  
P1000, P2000**

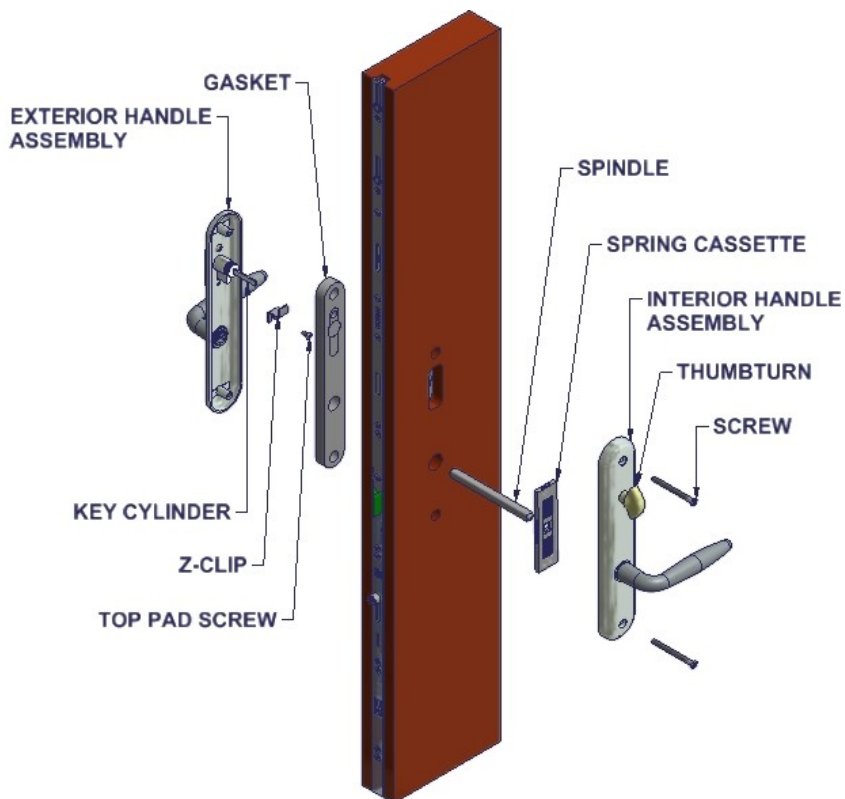

**Figure 1B (Thumb turn above handle):  
Handle orientation for  
AmesburyTruth Multi Point Lock  
systems Xcore™ and P3000**